

**Shaw  
& Co**  
ESTATE  
AGENTS



**£399,950**  
**Beaulieu Close**  
Hounslow, TW4 5EN

Shaw & Co



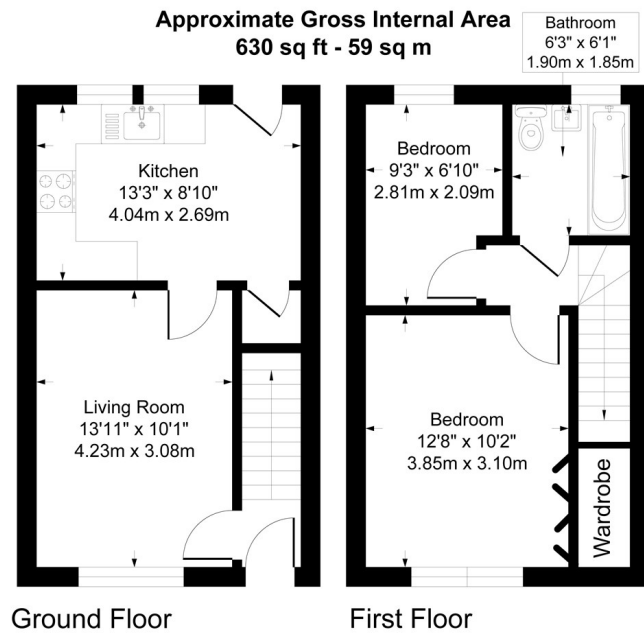

Although every attempt has been made to ensure accuracy, all measurements are approximate.  
This floorplan is for illustrative purposes only and not to scale.  
Measured in accordance with RICS Standards.

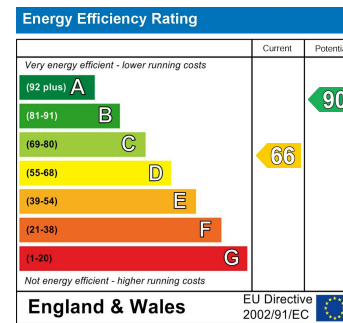

- 2 Bedroom House
- Chain Free
- Garden
- Driveway
- Close to Local Amenities
- Great Schools Catchment Area
- Quiet Residential Road
- Great Family Home

Agents Note: These particulars are for guidance only. All measurements area approximate and should be rechecked by buyers / tenants. While care has been taken to ensure accuracy, they should be solely relied upon.

**Shaw  
& Co**  
ESTATE  
AGENTS

**OFFICE ADDRESS**  
Whitton  
Twickenham  
TW2 7LT

**OFFICE DETAILS**  
0208 894 3646  
whitton@shawandcoestates.com